

# KEELER MILL RD.

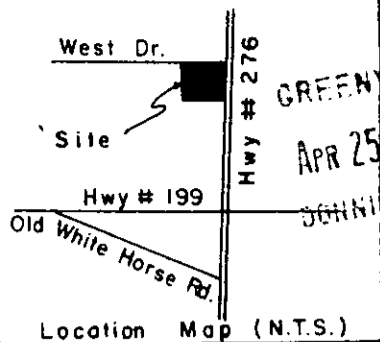

FILED  
GREENVILLE CO. S. C.  
APR 25 1 20 PM '86  
S. TANKERSLEY  
R.M.C.

N 22 - 36 E → 254.3'

33' R/W

I.P.N.

N 67 - 48 E  
59.0'

I.P.N.

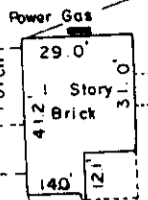

Gravel Drive

2.65 AC.

- KELLY -

N 66 - 23 W → 395.7'

S 66 - 56 E → 343.5'

U.S. HWY. # 276

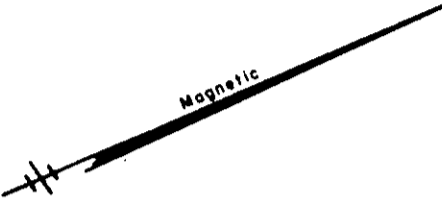

S 20 - 36 W → 300.4'

41' R/W

To Travelers Rest

- TATE -

SURVEY FOR

## T. C. PETERSON

NEAR MARIETTA

GREENVILLE COUNTY

SOUTH

CAROLINA

MARCH

20,

1986

APR 25 1986

12-R-2

To The Best Of My Knowledge This Structure Is Not In An Established Flood Zone.

35097 ✓

I Hereby Certify That The Measurements As Shown Above Are Correct And There Are No Encroachments Or Projections Other Than Shown.

I Hereby Certify That The Ratio Of Precision Of The Field Survey As Shown Hereon And The Area Was Determined By Computer.

**JEFFERY M. PLUMBLEE, INC.**  
LAND SURVEYING

P O BOX 788  
TRAVELERS REST. S. C. 29690 (803) 834-4426

35097 ✓

*Jeffery M. Plumblee*  
SURVEYOR

SOUTH CAROLINA REGISTERED PROFESSIONAL SURVEYOR  
7680

PLS # 7881

